

Plan of Basilica of Santi Quattro Coronati

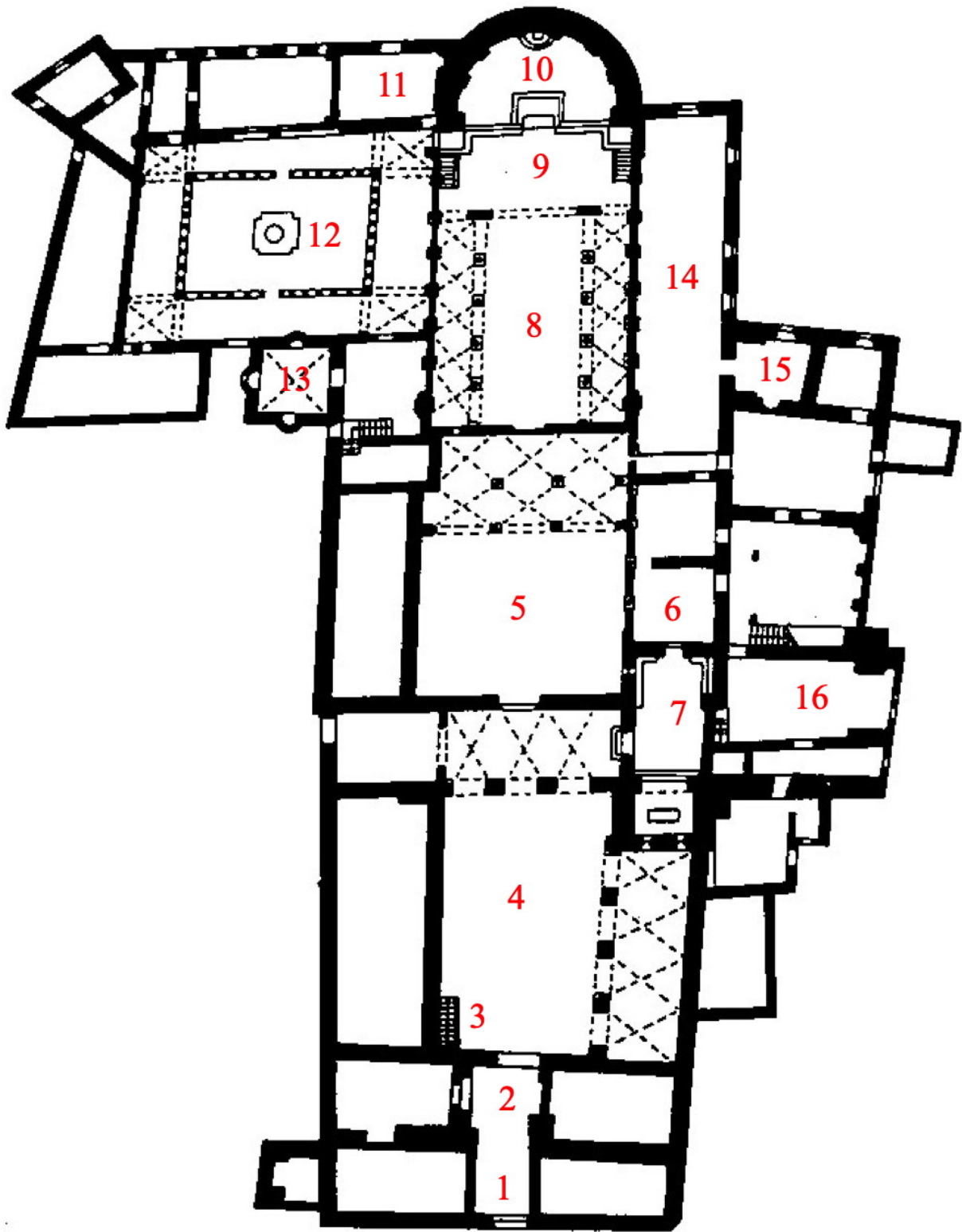

1. Entrance to the complex
2. Romanesque Campanile
3. Entrance to the monastery of the Little Sisters of the Lamb
4. First courtyard
5. Second courtyard and entrance to basilica
6. Atrium of the Augustinian monastery (Calendar room)
7. Chapel of San Silvestro
8. Nave
9. Transept and stairs to crypt
10. Sanctuary and Apse
11. Sacristy
12. Cloister
13. Chapel of Santa Barbara
14. Refectory of the Augustinian nuns
15. Chapel of San Nicola
16. Gothic Hall