

Plan of San Lorenzo in Damaso

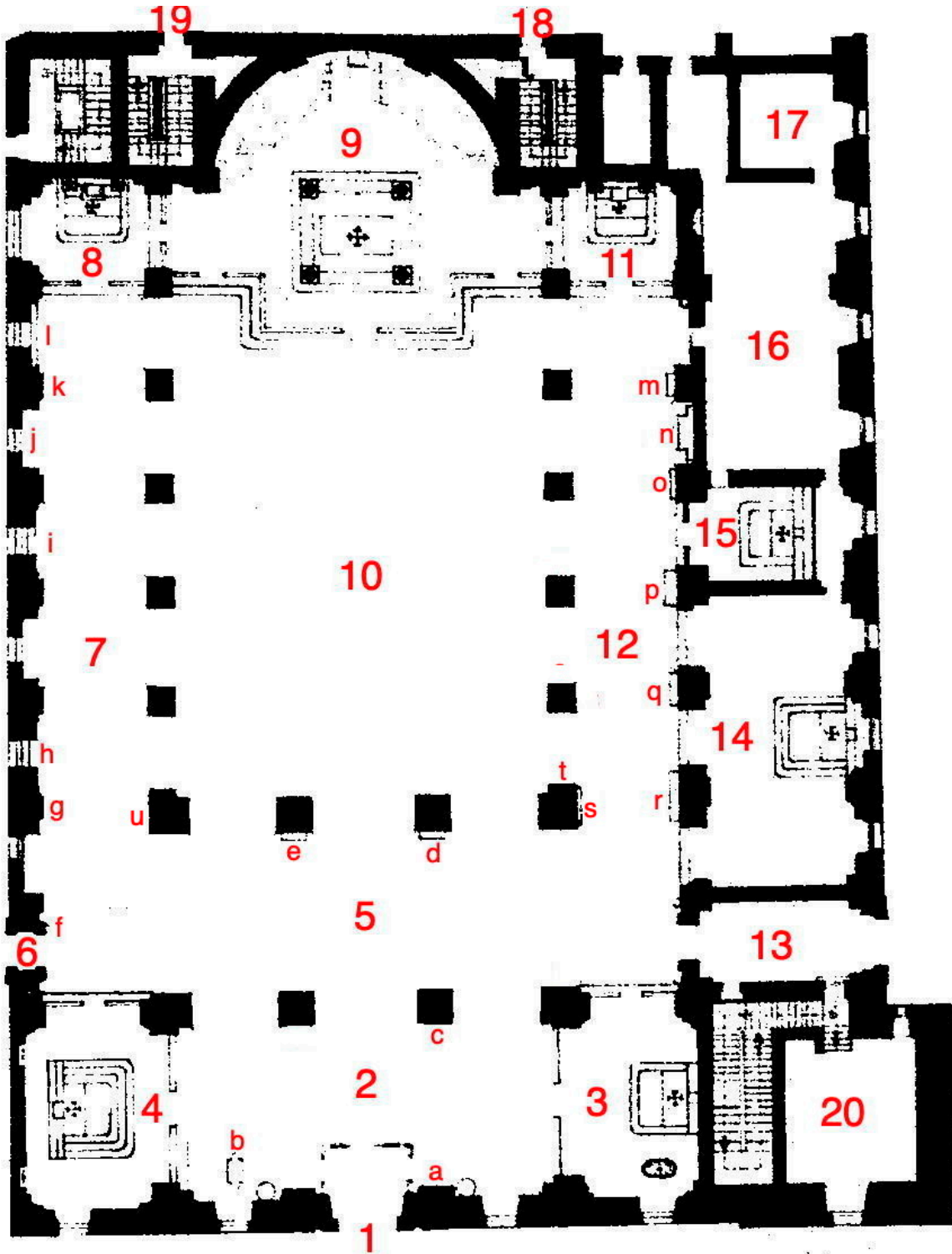

1. Main Entrance
2. 1st Narthex
3. Ruffo chapel and Baptismal Font
4. Cappella del Santissimo Sacramento or Ottoboni Chapel
5. 2nd Narthex
6. Entrance (reserve) to the arcaded courtyard of the palace
7. Left minor aisle
8. Chapel of the Sacrament and the Immaculate Conception
9. Sanctuary and High Altar
10. Central nave
11. Chapel of Our Lady of Pompei
12. Right minor aisle
13. Side Entrance, with Carved late 15th century marble doorcase
14. Fonseca Chapel or the Cappella del Crocifisso
15. Chapel of the Sacred Heart
16. Sacristy
17. Parish Office
18. Stairwell of the campanile
19. Stairs to organ loggia
20. Chapter Room of St. Lawrence
 - a. Monument for Alessandro Voltrini by Bernini
 - b. Statue of St. Hippolytus
 - c. Sepulcher by G. Pacini, doctor by G. A. Dosio
 - d. Statue of St. Carlo Borromeo by Stefano Maderno
 - e. Statue of St. Francis Xavier
 - f. Monument for Cardinal Luigi Amat over door to courtyard
 - g. Monument by Annibal Caro by G. A. Dosio
 - h. Tomb slab by Giuliano Galli
 - i. Monument of Count Aeneas de Caprara (1701)
 - j. Monument of Cardinal Luigi Traglia (1982)
 - k. Monument of Nicola Scagliosi
 - l. Monument of Card. Ludovico Trevisan known as Mezzarota Scarampi
 - m. Monument of Pellegrino Rossi (P. Tenerani)
 - n. Monument of Cardinal Antonino de Luca (G. Prinzi)
 - o. Plaque in memory of M. Antonia Olivieri
 - p. Monument of Cardinal Francesco Saverio Massimo
 - q. Monument of Maria Gabriella of Savoia Massimo (Pietro Tenerani)
 - r. Monument by Camillo Massimo and Cristina di Sassonia (F. Gnaccarini)
 - s. Monument of V. Rev. George Conn of Aberdeen
 - t. Monument of Siciolanti of Sermoneta
 - u. Monument for Antonio Cepparelli, and family