

## Plan of Sant'Ambrogio della Massima

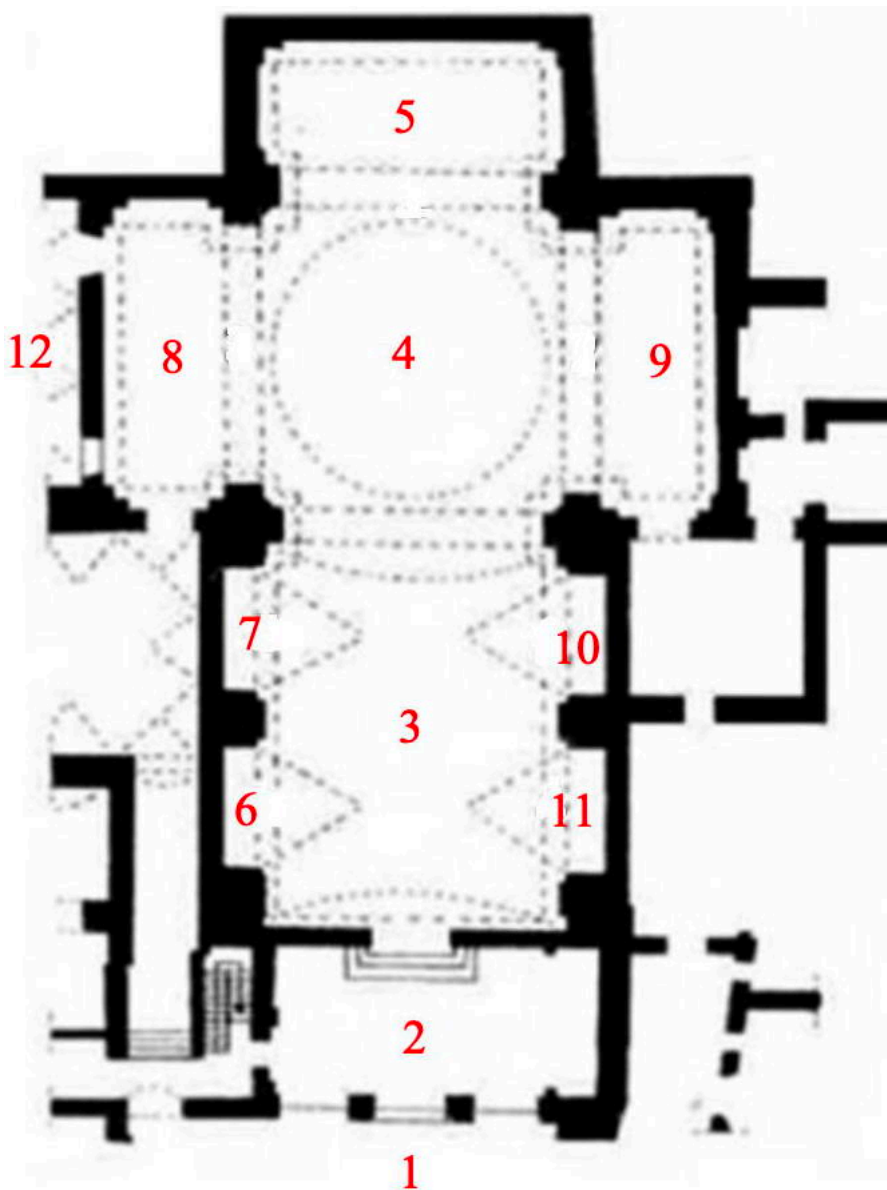

1. Courtyard and Façade
2. Entrance Portico
3. Nave
4. Dome
5. Sanctuary
6. Chapel of St. Joseph
7. Chapel of the BVM
8. Left transept / Altar of St. Maurus
9. Right transept / Altar of the Crucifixion
10. Chapel of St. Benedict
11. Chapel of St. Marcellina
12. Sacristy